

BAS Correction Historic Annex CO 2013-28: City of Cabot
 *for Census only - was already in state map

City: Cabot
 Mayor: Bill Cypert

Arkansas Code 14-40-101.

Before an entity undertakes an annexation, consolidation, or detachment proceeding under this chapter, the entity shall coordinate with the Arkansas Geographic Information Systems Office for preparation of legal descriptions and digital mapping for the relevant annexation, consolidation, and detachment areas.

The map contained herein, is evidence, the entity has met requirements of Act 914 of 2015

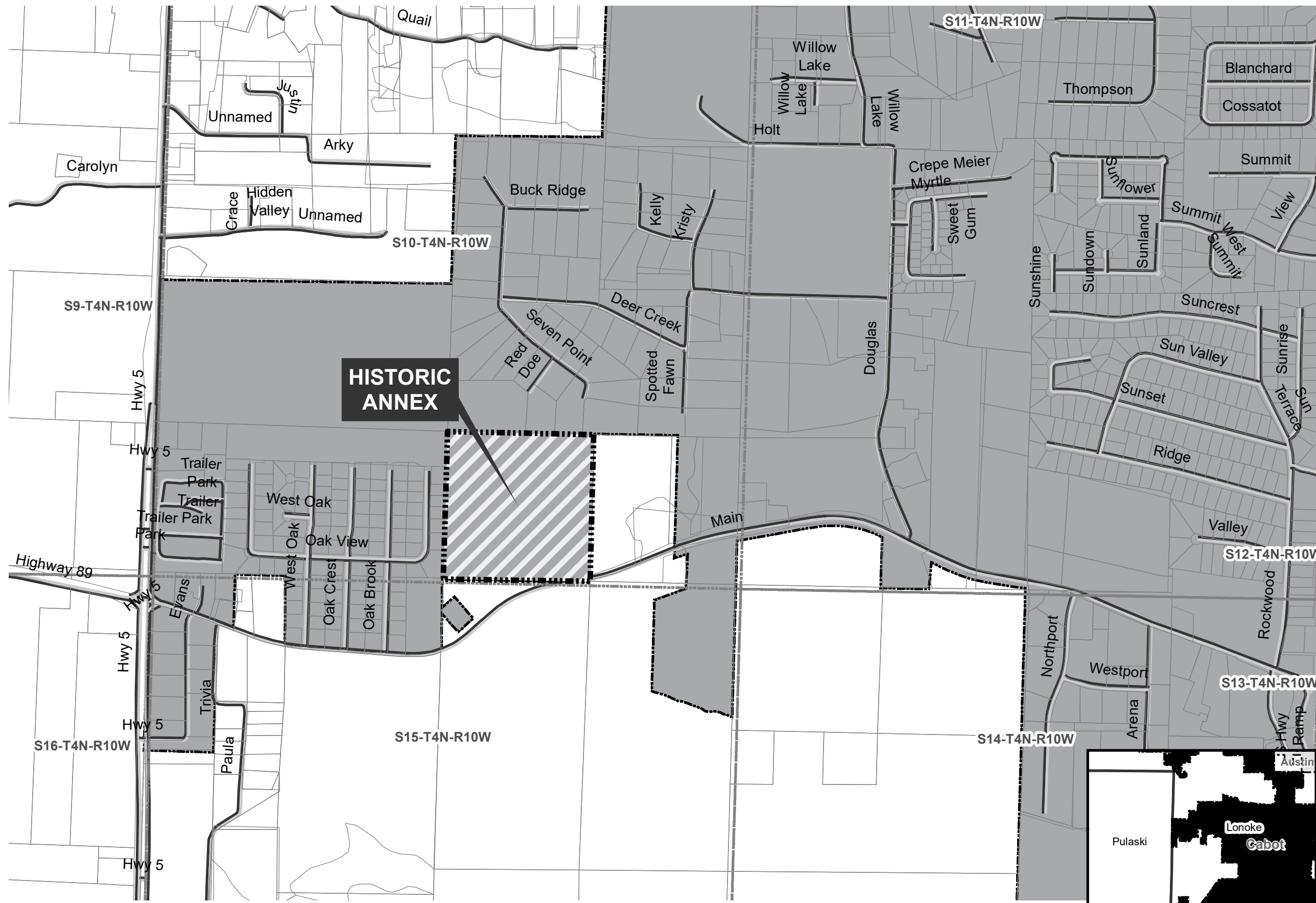

- Proposed Annex
- Sections
- Parcels
- Minor Road
- Existing City
- Neighboring City
- County Boundary

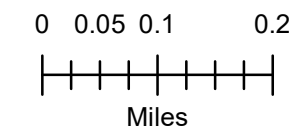

March 21, 2014

The Honorable Larry Clarke
Lonoke County Clerk
P.O. Box 188
Lonoke, AR 72086

RE: Annexation

Dear Mr. Clarke,

The following information was recently received and has been recorded and filed in the office of the Secretary of State:

County: Lonoke City: Cabot

Annexation: Petition: C2013-28 – Filed March 4, 2013
 Proof of Notice: Dated August 6, 2013
 County Court Order: C2013-28 – Filed April 9, 2013
 City Ordinance: ~~C2013-28~~ – Filed May 14, 2013
 Plat 13 of 2013 03262014 RWN

By copy of this letter, I am sending file marked copies of all of the information to the UALR Institute for Economic Advancement, Arkansas Highway Mapping Department, and TomTom. All others listed will only receive notification of the annexation by copy of this letter.

If you have any questions please do not hesitate to contact me at 1-800-482-1127 or 501-682-3451

Sincerely,

Ryan Norris
Voter Services Project Administrator
Arkansas Secretary of State

cc: UALR Institute for Economic Advancement (w/encl)
Arkansas Highway Mapping Department (w/encl)
TomTom (w/encl)
Arkansas Municipal League (w/o encl)
Tammy Yocom, Clerk/Treasurer (w/o encl)
Shelby Johnson, State Geographic Information Officer GIS (w/o encl)

FILED

MAR 21 2014

Arkansas
Secretary of State

IN THE COUNTY COURT OF LONOKE COUNTY, ARKANSAS

IN THE MATTER OF ANNEXING
CERTAIN TERRITORY CONTIGUOUS TO
THE CITY OF CABOT, LONOKE COUNTY,
ARKANSAS

2013 MAR -4 AM 11:00

LONOKE COUNTY CLERK
LARRY CLARKE

BY [Signature] D.C.

NO: C-2013-28

ANNEXATION PETITION

Comes the undersigned Petitioners and for their Annexation Petition, state:

1. That the undersigned represent a totality of the real estate owners of the within described real property as defined in Ark. Code. Ann. Section 14-40-601 (b).
2. That they desire that the following real property be annexed to and made a part of the City of Cabot, Lonoke County, Arkansas:

The Southwest Quarter (SW1/4) of the Southeast Quarter (SE1/4) of Section Ten (10), Township Four (4) North of Range Ten (10) West in Lonoke County, Arkansas, containing 40 acres more or less.
3. That the above-described property is contiguous to and adjoining the present corporate limits of the City of Cabot, Lonoke County, Arkansas.
4. That an accurate survey map thereof has been made and attached hereto as Exhibit "A" and made a part hereof.
5. That Patsy Wilson has been appointed and authorized to act on behalf of the Petitioners.

WHEREFORE, Petitioners pray that the Clerk file this Petition, and that the Court set a date not less than thirty (30) days after the filing of this Petition for a Hearing on the Petition for the annexing of the above-described property.

CERTIFIED COPY

STATE OF ARKANSAS, COUNTY OF LONOKE
I, Larry Clarke, County Clerk within and to the County and State
aforesaid, do hereby certify that the annexed and foregoing instrument of writing is
a true and correct copy of Annexation Petition Recorded on
this 10 day of Jan 2014 Recorded Book Vol. 17 Page 309-311
IN TESTIMONY WHEREOF I have hereunto set my hand and affixed the seal of
said Court on the 10 day of Jan 2014
[Signature] Clerk
[Signature] Deputy Clerk

RECORDED

BOOK 17 PAGE 309

PETITIONERS

ADDRESS

Patsy A. Wilson 3310 W. MAIN Cabot, Ark. 72023
Ronald E. Byrns 322 W MAIN ST. CABOT, AR 72023
Kathy D Byrns 322 W MAIN ST. CABOT, AR 72023

ACKNOWLEDGMENT

STATE OF ARKANSAS)
COUNTY OF LONOKE)

On this day, before me, the undersigned, a Notary Public, duly commissioned, qualified, and acting, within and for said County and State, appeared in person the within named Petitioner, Patsy Wilson, Trustee of the Patsy Wilson Living Trust dated November 23, 2011, to me personally well known, whose name is subscribed to the foregoing instrument and acknowledged that she had executed the same for the purposes set forth therein and that the facts so stated were true to the best of her knowledge and belief.

IN TESTIMONY WHEREOF, I have hereunto set my hand and official seal on this 20th day of FEBRUARY, 2013.
My commission expires: 9-1-2020
Valerie Sue Wilson
Notary Public



ACKNOWLEDGMENT

STATE OF ARKANSAS)
COUNTY OF LONOKE)

On this day, before me, the undersigned, a Notary Public, duly commissioned, qualified, and acting, within and for said County and State, appeared in person the within named Petitioners, Ronald E. Byrns and Kathy D. Byrns, to me personally well known, whose names are subscribed to the foregoing instrument and acknowledged that they had executed the same for the purposes set forth therein and that the facts so stated were true to the best of their knowledge and belief.

IN TESTIMONY WHEREOF, I have hereunto set my hand and official seal on this 27th day of FEBRUARY, 2013.
My commission expires: 9-1-2020
Valerie Sue Wilson
Notary Public



RECORDED

BOOK 17 PAGE 318

C-2013-28 FILED

MAR 04 2013

LONOKE CO. CLERK LARRY CLARKE
BY *[Signature]*

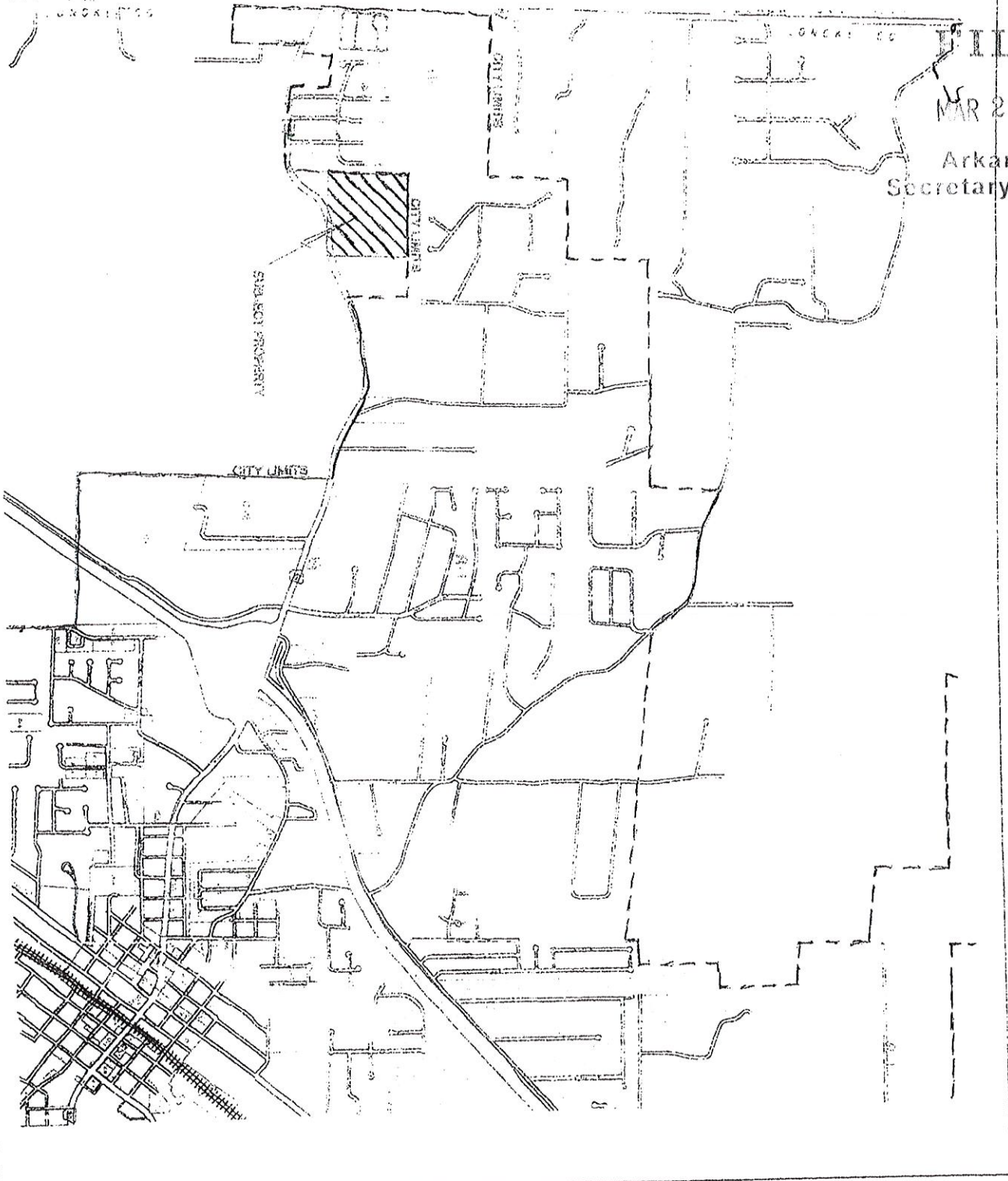

FILED

MAR 21 2014

Arkansas
Secretary of State

RECORDED

MAR 21 2014

Arkansas
Secretary of State

IN THE LONOKE COUNTY COURT IN THE MATTER OF ANNEXING TO
THE CITY OF CABOT, ARKANSAS, CERTAIN TERRITORY CONTIGUOUS
TO THE SAID CITY OF CABOT, ARKANSAS

NO. C2013-28

ORDER

2013 APR -9 AM 10:35
FILED
LONOKE COUNTY CLERK
KERRY CLARKE

On this a regular day of a regular term of the County Court of Lonoke County, Arkansas, there is presented to the Court by Patsy Wilson, agent of the petitioners, a petition for annexation of certain territory, hereinafter more particularly described, to the City of Cabot, Arkansas, and the Court being fully advised of the facts and the law, doth hereby find, judge and decree as follows:

The Court finds that the petition was filed more than thirty (30) days prior to this date and that in said petition the said Patsy Wilson was selected by the petitioners to act on their behalf in filing and presenting the petition.

The Court doth find that a majority of the total number of real estate owners in the area affected by this petition have signed said petition and that such majority owns more than one-half of the acreage affected.

The Court further finds that the territory sought to be annexed was accurately described in said petition and that said territory is contiguous to the boundaries of the City of Cabot, Arkansas.

The Court further finds that attached to and made a part of said petition is an accurate map of the territory sought to be annexed to the City of Cabot.

The Court further finds that the prayer of the petition is right and proper.

WHEREFORE, the Court doth hereby ORDER, JUDGE and DECREE that the following described territory be and the same is hereby annexed to and made a part of the City of Cabot, Arkansas, to-wit:

The Southwest Quarter (SW1/4) of the Southeast Quarter (SE1/4) of Section Ten (10), Township Four (4) North of Range Ten (10) West in Lonoke County, Arkansas, containing 40 acres more or less.

The Court doth further order that the original papers in this cause be delivered to the Clerk of Lonoke County, Arkansas, same to be properly recorded upon the records of Lonoke County, Arkansas, and the Clerk, after properly recording and filing the original papers, prepare transcripts of same; that one of the certified transcripts be delivered to the

RECORDED
BOOK 17 PAGE 312

City of Cabot, Arkansas; one copy to the Secretary of State, and one copy to the Director of the Tax Division of the Arkansas Public Service Commission.

DATED THIS 9 DAY OF April 2013.

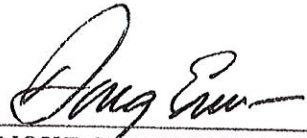

LONOKE COUNTY JUDGE

CERTIFIED COPY
STATE OF ARKANSAS, COUNTY OF LONOKE
I, Lamy Clark, County Clerk within and to the County and State aforesaid, do hereby certify that the annexed and foregoing instrument of writing is a true and correct copy of Order Recorded on this 10 day of Jan, 2014 Recorded Book Vol. 17 Page 312-313
IN TESTIMONY WHEREOF I have hereunto set my hand and affixed the seal of said Court on the 10 day of January, 2014
By Lamy Clark Clerk
Bob McDaniel Deputy Clerk

RECORDED

BOOK 17 PAGE 313

18/32

C-2013-28



FILED
DEC 19 2013
LONOKE CO. CLERK LARRY CLARKE
BY *[Signature]*

ORDINANCE NO. 13 of 2013

AN ORDINANCE ACCEPTING THE ANNEXATION OF CERTAIN TERRITORY TO THE CITY OF CABOT, ARKANSAS, AND MAKING SAME A PART OF THE CITY OF CABOT, ARKANSAS, ASSIGNING SAME TO WARDS, AND ZONING SAID ANNEXED TERRITORY; DECLARING AN EMERGENCY; AND FOR OTHER PURPOSES

MAR 21 2014

Arkansas
Secretary of State

WHEREAS, a Petition was filed on the 4th day of March 2013, with the County Clerk of Lonoke County, Arkansas, by the majority of the real estate owners of the hereinafter described territory praying that said territory be annexed to, and made a part of the City of Cabot, Arkansas; and,

WHEREAS, on the 9th day of April 2013, the County Court of Lonoke County, Arkansas, found that the Petition was signed by a majority of the real estate owners in said territory; that said territory was contiguous and adjoining the present corporate limits of the City of Cabot, Arkansas; that an accurate plat or map of said territory had been filed with and made a part of said Petition; that proper notice had been given for the time and in the manner prescribed by law, and that all things pertaining thereto had been done in the manner prescribed by law, and that said lands and territory should be annexed to and made a part of the City of Cabot, Arkansas, subject to the acceptance of same by the City Council of said City at the proper time, as provided by law; and,

WHEREAS, necessary urban services, such as fire and police protection and ambulance services are to be extended to such area within a reasonable period of time; and

WHEREAS, the time fixed by law for appealing from said Order of Annexation made by the County Court has expired and no appeal has been taken from said Order.

NOW, THEREFORE, BE IT ORDAINED BY THE CITY COUNCIL OF THE CITY OF CABOT, ARKANSAS:

SECTION 1: The following described lands and territories annexed to the City of Cabot, by Order of the County Court of Lonoke County, Arkansas, by its Order of April 9, 2013, be and are hereby accepted by the City of Cabot, Arkansas, said territory hereinafter described shall be hereafter deemed and taken to be a part and parcel of the limits of the City of Cabot, Arkansas, and the inhabitants residing therein shall have and enjoy all of the rights and privileges of the inhabitants within the original limits of the City of Cabot, Arkansas.

RECORDED

BOOK 17 PAGE 305

SECTION 2: The lands and territories are hereby annexed to and accepted by the City of Cabot, Arkansas, and particularly described as follows:

The Southwest Quarter (SW1/4) of the Southeast Quarter (SE1/4) of Section Ten (10), Township Four (4) North of Range Ten (10) West in Lonoke County, Arkansas, containing 40 acres more or less.

SECTION 3: The above described annexed lands and territories are hereby assigned and attached to Ward 2 of the City of Cabot, Arkansas, and the same shall henceforth be a part of said ward as fully as existing parts of said ward.

SECTION 4: A portion of the above described annexed lands and territories are hereby zoned C-2 as follows:

*The South Five Hundred Feet (500') of a tract of land described as:
The Southwest Quarter (SW 1/4) of the Southeast Quarter (SE 1/4) of Section Ten (10),
Township Four (4) North of Range Ten (10) West in Lonoke County, Arkansas,
containing 40 acres more or less.*

LESS AND EXCEPT:

A part of the Southwest Quarter (SW 1/4), Southeast Quarter (SE 1/4), Section 10, Township 4 North (T-4-N), Range 10 West (R-10-W), Lonoke county, Arkansas, and being more particularly described as follows: Beginning 485.0 ft. South of the Northeast Corner of said SW 1/4, SE 1/4, Section 10; thence South 479.7 ft.; thence N-48° 10'-W, 668.7 ft.; thence N-86° 08'-E, 499.45 ft. to the point of beginning and containing 2.74 more or less.

and all other portions of this forty acre tract (less and except that tract previously described above as C-2) shall be R-1.

SECTION 5: Emergency. Whereas, it is found and declared by the City Council of the City of Cabot, Arkansas, that there is now an extreme urgency that the lands and territories herein be immediately annexed to and accepted by the City of Cabot, Arkansas, so that said property and the citizens and property owners of said lands and territories described herein can be entitled to fire and police protection, zoning, and other protection and benefit; that said benefits and protections are urgently needed now in order to allow orderly growth and development of said

RECORDED

BOOK 17 PAGE 306

C-2013-28 FILED

MAR 04 2013

LONOKE CO. CLERK LARRY CLARKE
BY *[Signature]*

FILED

MAR 21 2014

Arkansas
Secretary of State

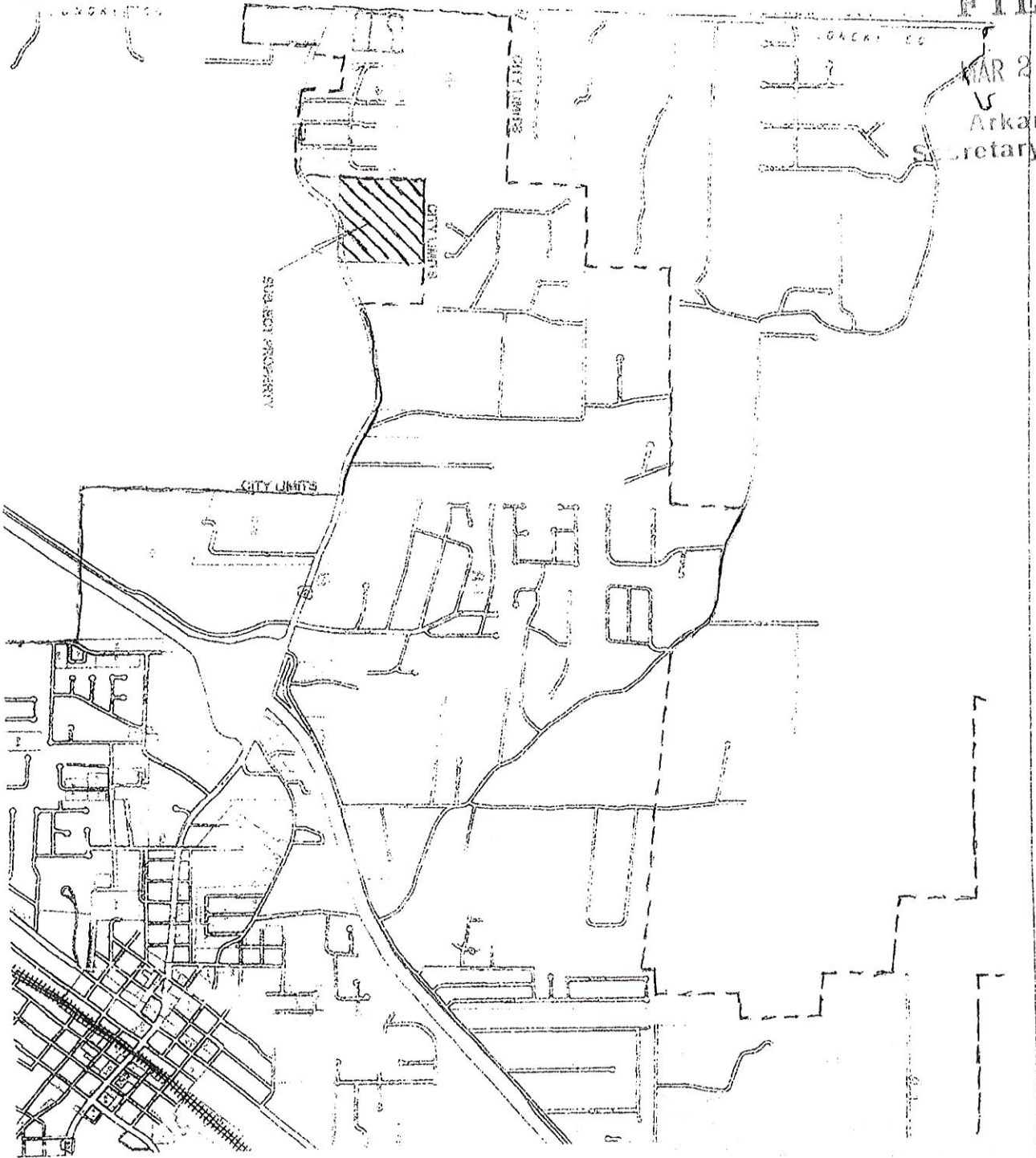

RECORDED

LEADER PUBLISHING, INC.

P.O. Box 766 • 404 Graham Road • Jacksonville, Ark. • 72076
105 North 8th Street • Cabot, Ark. • 72023
(501) 982-9421 • (501) 941-5132 • 501-985-0026 (Fax)

*Publishers of The Leader on Wednesdays and Saturdays in North Pulaski, Lonoke, White and Prairie Counties
Combat Airlifter — The only officially sanctioned newspaper at Little Rock Air Force Base
The Arkansas Minuteman, serving the Arkansas National Guard and their families*

State of Arkansas

County of Pulaski
County of Lonoke

This is to certify that the attached legal advertisement
being City of Cabot

In the matter of Ordinance no. 13 of 2013

versus

pending in the _____
court of said county, was published for 1

consecutive times on the following dates:

July 27th, 2013, _____, 2013,
_____, 2013, _____, 2013,
_____, 2013, _____, 2013,

in the regular edition of The Leader, a newspaper of
general bona fide circulation, having a Periodical Postal
Permit and published continuously for a period of more
than one year in the County of Lonoke, County of Pulaski,
County of White or County of Prairie, State of Arkansas.

PUBLICATION FEE.....\$ 113²⁸

By: Thomas Alvis
(for Garrick Feldman, publisher)

State of Arkansas
County of Lonoke

SUBSCRIBED AND SWORN TO BEFORE ME ON THIS
27 DAY OF August 2013.

Joseph M. Robinson
(Joseph M. Robinson)
Notary Public, Lonoke Co., Arkansas
Commission #12388483
My commission expires July 25, 2022

LEGAL NOTICE

LEGAL NOTICE as published
in the July 27th, 2013 Edition,
of The Leader.

ORDINANCE NO. 13 of 2013

AN ORDINANCE ACCEPT-
ING THE ANNEXATION
OF CERTAIN TERRITORY
TO THE CITY OF CABOT,
ARKANSAS, AND MAK-
ING SAME A PART OF THE
CITY OF CABOT, ARKAN-
SAS, ASSIGNING SAME TO
WARDS, AND ZONING SAID
ANNEXED TERRITORY, DE-
CLARING AN EMERGENCY,
AND FOR OTHER PUR-
POSES

WHEREAS, A Petition was
filed on the 4th day of March
2013, with the County Clerk
of Lonoke County, Arkansas,
by the majority of the real es-
tate owners of the hereinafter
described territory praying
that said territory be annexed
to, and made a part of the
City of Cabot, Arkansas; and,

WHEREAS, ON the 9th day of
April 2013, the County Court
of Lonoke County, Arkansas,
found that the Petition was
signed by a majority of the
real estate owners in said
territory; that said territory
was contiguous and adjoin-
ing the present corporate
limits of the City of Cabot,
Arkansas; that an accurate
plat or map of said territory
had been filed with and
made a part of said Petition;
that proper notice had been
given for the time and in the
manner prescribed by law,
and that all things pertaining
thereto had been done in the
manner prescribed by law,
and that said lands and ter-
ritory should be annexed to
and made a part of the City
of Cabot, Arkansas, subject
to the acceptance of same
by the City Council of said
City at the proper time, as
provided by law; and,

WHEREAS, NECESSARY
urban services, such as fire
and police protection and
ambulance services are to
be extended to such area
within a reasonable period of
time; and

WHEREAS, THE time fixed
by law for appealing from
said Order of Annexation
made by the County Court
has expired and no appeal
has been taken from said
Order.

NOW, THEREFORE, BE IT
ORDAINED BY THE CITY
COUNCIL OF THE CITY OF
CABOT, ARKANSAS:

SECTION 1: The following de-
scribed lands and territories
annexed to the City of Cabot,
by Order of the County Court
of Lonoke County, Arkansas,
by its Order of April 9, 2013,
be and are hereby accepted
by the City of Cabot, Arkan-
sas, said territory hereinafter
described shall be hereafter
deemed and taken to be a
part and parcel of the limits of
the City of Cabot, Arkansas,
and the inhabitants residing
therein shall have and enjoy
all of the rights and privileges
of the inhabitants within the
original limits of the City of
Cabot, Arkansas.

SECTION 2: The lands and
territories are hereby an-
nexed to and accepted by
the City of Cabot, Arkansas,
and particularly described as
follows:

THE SOUTHWEST Quarter
(SW1/4) of the Southeast
Quarter (SE1/4) of Section
Ten (10), Township Four
(4) North of Range Ten (10)
West in Lonoke County, Arkan-
sas, containing 40 acres
more or less.

SECTION 3: The above de-
scribed annexed lands and
territories are hereby as-
signed and attached to Ward
2 of the City of Cabot, Arkan-
sas, and the same shall
henceforth be a part of said
ward as fully as existing parts
of said ward.

SECTION 4: A portion of the
above described annexed
lands and territories are
hereby zoned C-2 as follows:

THE SOUTH Five Hundred
Feet (500') of a tract of land
described as:

THE SOUTHWEST Quarter
(SW 1/4) of the Southeast
Quarter (SE 1/4) of Section
Ten (10), Township Four
(4) North of Range Ten (10)
West in Lonoke County, Arkan-
sas, containing 40 acres
more or less.

LESS AND EXCEPT:

A PART of the Southwest
Quarter (SW 1/4), Southeast
Quarter (SE 1/4), Section 10,
Township Four (T-4-N),
Range Ten (R-10-W),
Lonoke County, Arkansas,
described as follows: Begin-

ning 485.0 ft. South of the
Northeast Corner of said SW
1/4, SE 1/4, Section 10; thence
South 479.7 ft.; thence N-48°
10'-W, 668.7 ft.; thence
N-86° 08'-E, 499.45 ft. to
the point of beginning and
containing 2.74 more or less.

AND ALL other portions of
this forty acre tract (less and
except that tract previously
described above as C-2)
shall be R-1.

SECTION 5: Emergency.
Whereas, it is found and de-
clared by the City Council of
the City of Cabot, Arkansas,
that there is now an extreme
urgency that the lands and
territories herein be immedi-
ately annexed to and accept-
ed by the City of Cabot, Arkan-
sas; so that said property,
and the citizens and property
owners of said lands and ter-
ritories described herein can
be entitled to fire and police
protection, zoning, and other
protection and benefit; that
said benefits and protec-
tions are urgently needed
now in order to allow orderly
growth and development of
said lands and territories.
Therefore, an emergency is
hereby declared to exist; this
Ordinance being necessary
for the preservation of pub-
lic peace, health and safety
shall take effect and be in
full force and effect from and
after its passage.

SPONSOR: MAYOR William
A. "Bill" Cypert

PASSED: 7-0-1 (Gilliam - Ab-
stain)

DATE: 7.15.13

APPROVED: WILLIAM "Bill"
A. Cypert, Mayor

APPROVED AS TO FORM:
Jim Taylor, City Attorney

ATTEST: TAMMY Yocom,
City Clerk-Treasurer

FILED

MAR 21 2014

Arkansas
Secretary of State

RECORDED

BOOK 17 PAGE 314

